

SERVICE BULLETIN

Revolution Helm Chair - Cable Actuator Spring Installation Instructions

STEPS

- 1 Detach helm chair from pedestal and slide by removing 4 bolts

- 2 Remove O-Ring from Gas Spring Release Head
NOTE: The O-Ring will not be reused

- 3 Remove the Stop-Nut from the trigger Cradle on the Gas Spring Release Head; Loosen set screw on Stop-Nut using a small flat head screwdriver; Remove Stop-Nut from release cable

**NOTE: SAVE THIS PART!
The Stop-Nut will be reused in step 8**

- 4 Slide the stainless steel Spring (included in the service kit) onto the release cable

- 5 Slightly compress stainless steel Spring so that it fits snugly between Cradle and cable Gland

- 6 Thread release cable through Stop-Nut (removed in step 3); Firmly seat the Stop-Nut in the Cradle

- 7 Using a small flat head screwdriver tighten the set screw in the Stop-Nut; Pull release cable to remove all slack prior to tightening set screw (Recline button will be in the outermost position)

- 8 Feed excess release cable through the eye of the cotter pin securing the clevis pin for the Gas Spring Release Head to prevent possible cable obstruction or entanglement with the seat slide

- 9 **Service Kit Installation Complete**
Reinstall helm chair onto slide and pedestal

TOOL NEEDED

Small Flat Head Screwdriver

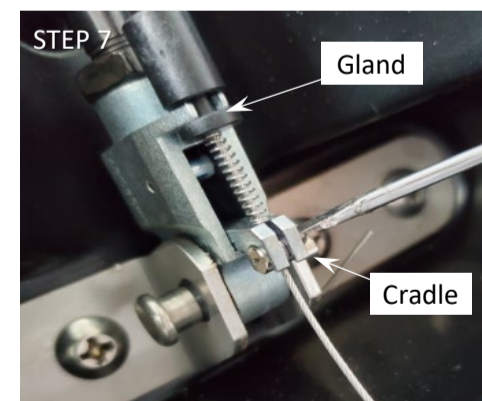
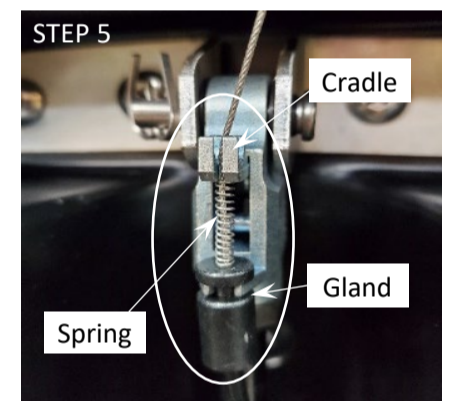
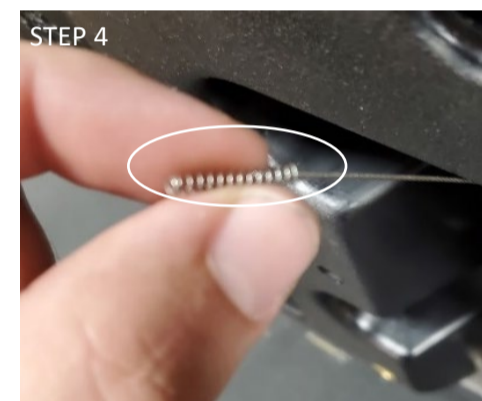
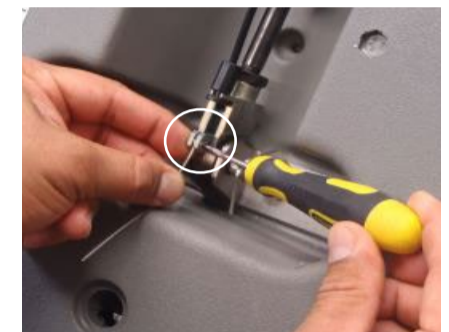
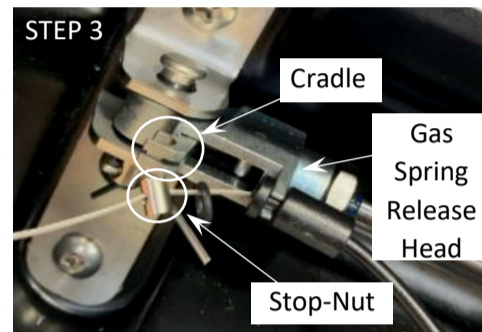
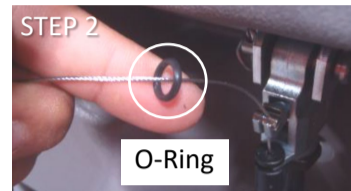

NOTE: The newly installed stainless steel Spring will keep the Gas Spring Release Head trigger Cradle pushed away from the cable Gland