

INSTALLATION INSTRUCTIONS

Accessory PREMIUM REMOTE CONTROL KIT

P/N: 06240-ZW5-U40,U60,U00,U20
06240-ZW5-U50,U70,U10,U30

Application Outboards

BF25/30/40/50
BF75/90/115/130

Publication No.

Issue Date
April 2001

GENERAL

Install the remote control kit following the instructions in this manual. Proper installation is essential for your safety and proper operation of the product. **This accessory is designed for use with Honda outboard motors only. This controller does not provide start-in-gear protection.**

An authorized Honda Marine or Honda Outboard Motor dealer must make the installation.

Wear gloves, goggles and protective clothes during the installation. Install the remote control using the specified tools as needed.

SAFETY PRECAUTIONS

- Tighten the bolts, nuts and other fasteners securely to the specified torque.
- Loose or missing bolts and nuts will deteriorate the remote control performance possibly causing serious personal injury or equipment damage.
- Standard Torque

American bolt diameter and thread size

Item	N·m	kgf·m	lbf·ft	Item	N·m	kgf·m	lbf·ft
1/4 inch-20	11	1.1	8	3/8 inch-16	30	3.1	22
5/16 inch-18	16	1.6	12	1/2 inch-13	103	10.5	76

Metric bolt diameter

Item	N·m	kgf·m	lbf·ft	Item	N·m	kgf·m	lbf·ft
5mm Bolt and nut	5	0.5	3.6	5mm Screw	4	0.4	2.9
6mm Bolt and nut	10	1.0	7	6mm Screw and SH bolt	9	0.9	6.5
8mm Bolt and nut	22	2.2	16	6mm Flange bolt and nut	12	1.2	9
10mm Bolt and nut	34	3.5	25	8mm Flange bolt and nut	26	2.7	20
12mm Bolt and nut	54	5.5	40	10mm Flange bolt and nut	39	4.0	29

INCHES

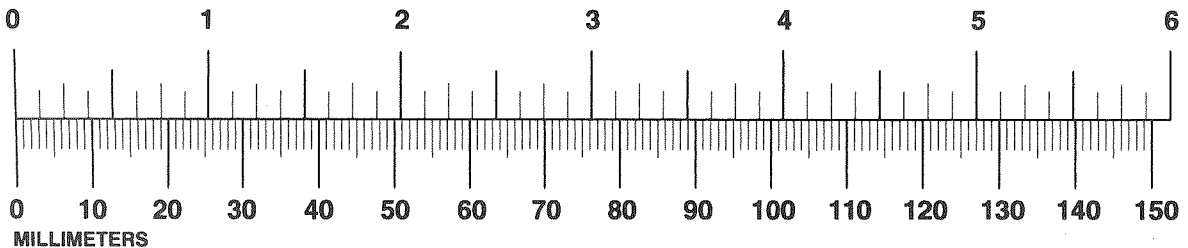

5/8 in 9/16 in 1/2 in 7/16 in 3/8 in 5/16 in 1/4 in

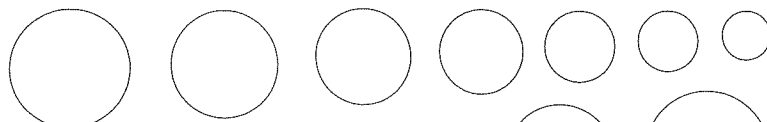

5 mm 6 mm 8 mm 10 mm 12 mm 14 mm 16 mm

WASHERS ARE SPECIFIED BY INSIDE DIAMETER

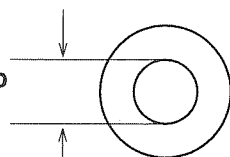

NUTS ARE SPECIFIED BY INSIDE DIAMETER (AT THREAD DEPTH)

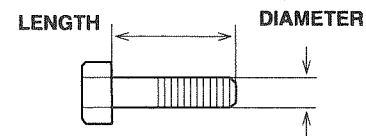
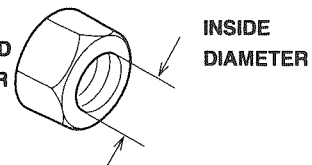

COMPONENTS OF THE REMOTE CONTROL KIT

Take out all parts from the kit and check them against the parts list shown below. Be sure all parts listed in the parts list are contained in the package.

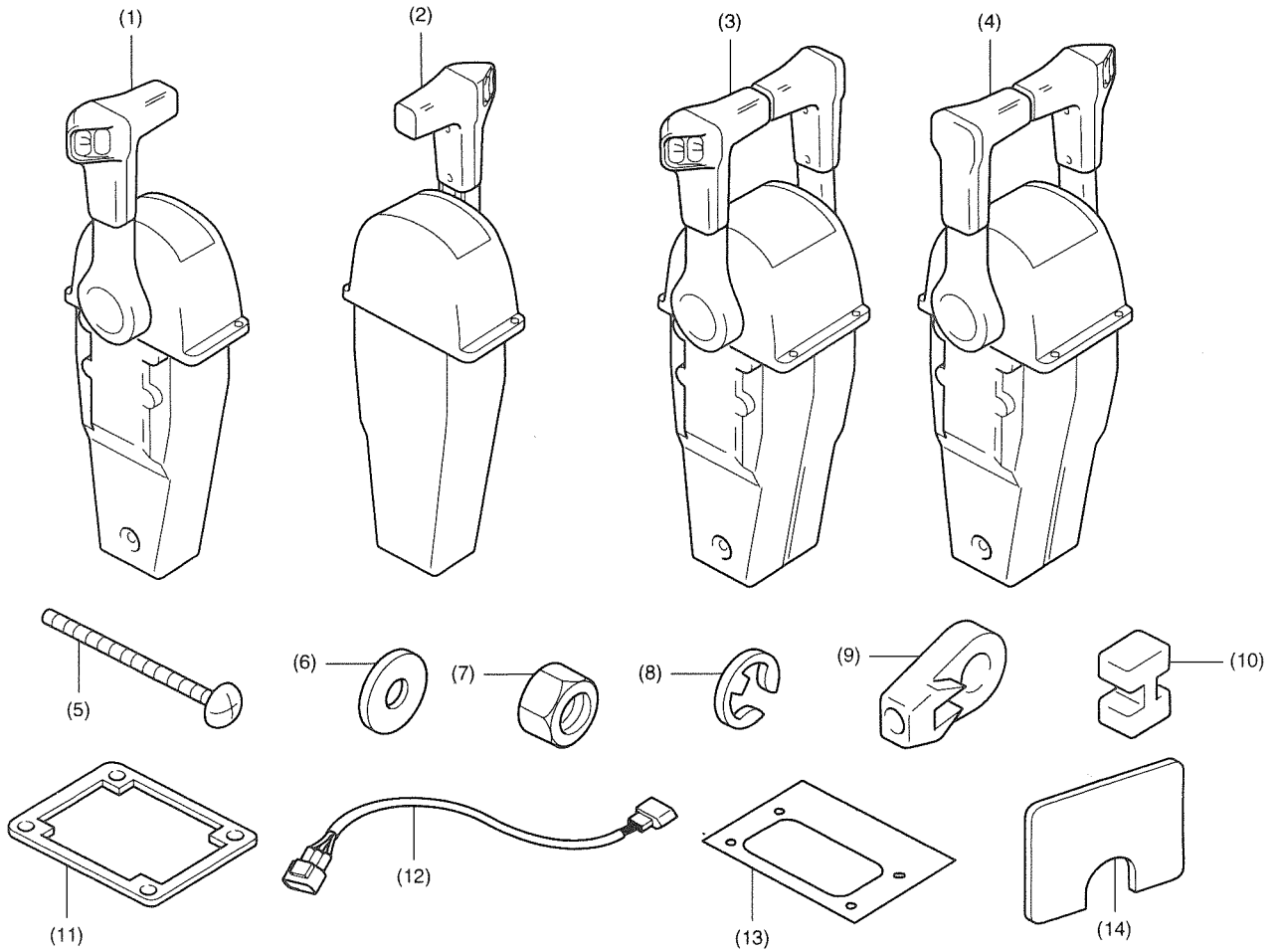

Index No.	Part Name	RT.HD	LT.HD	RT.HD	LT.HD
		Single Lever	Single Lever	Dual Lever	Dual Lever
		Quantity			
(1)	Remote control (right-hand handle, single lever type)	1			
(2)	Remote control (left-hand handle, single lever type)		1		
(3)	Remote control (right-hand handle, dual lever type)			1	
(4)	Remote control (left-hand handle, dual lever type)				1
(5)	5 x 40 mm Pan-head screw	4	4	4	4
(6)	5 mm Washer	4	4	4	4
(7)	5 mm Nut	4	4	4	4
(8)	E-ring	2	2	4	4
(9)	Remote control cable end	2	2	4	4
(10)	Cable clamp spacer	1	1	2	2
(11)	Packing			1	1
(12)	Sub Harness Assembly (Red)		1	1	1
	Sub Harness Assembly (Blue)	1		1	1
(13)	Template	1	1	1	1
(14)	Guide Plate (give the guide plate to the customer for future use)	1	1	1	1

* On the right-hand / left-hand single lever type, the packing (ref. #11) is mouted on the remote control.

COMPONENT IDENTIFICATION

This section shows you the right-hand handle type only. The right-hand remote control is designed so that you can perform the throttle operation and the tilt angle adjustment with your right hand. Note that the name and operation of each part of the left-hand handle type are identical with those of the right-hand handle type.

Top Mount Remote Control (right-hand handle type shown)

Single top-Mount Remote Control

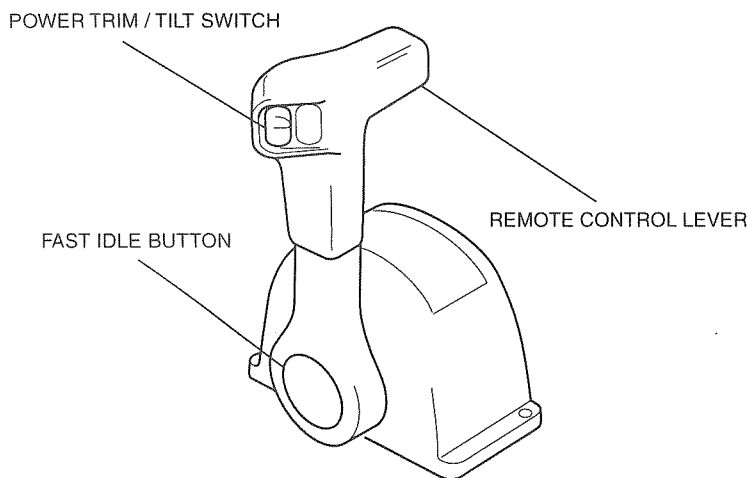

Dual top-Mount Remote Control

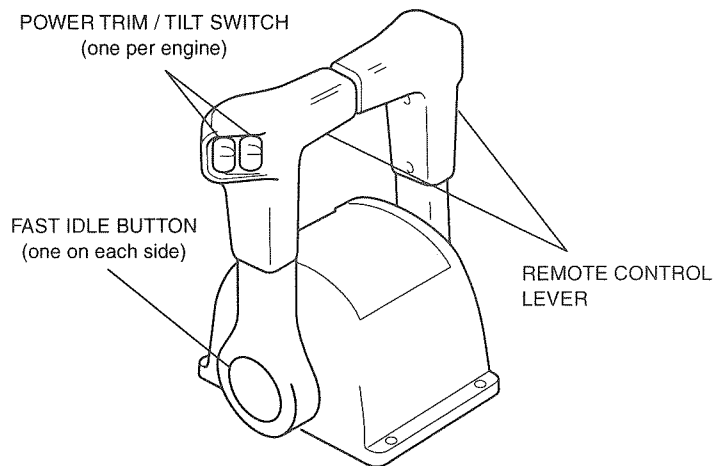

Remote Control Lever The remote control lever controls gear selection and throttle opening positions.

Power Trim/Power Tilt **For power trim**
Press the power trim / tilt switch on the remote control lever to adjust the motor trim angle to maintain proper boat trim.

For power tilt
Press the power trim / tilt switch on the remote control lever to adjust the motor tilt angle.

Fast Idle Button Used for engine starting and warm-up. With the fast idle button pushed in, the remote control lever can be moved forward or backward. This opens and closes the throttle without engaging the propeller.

SWITCH PANEL (Optional on BF25/30/40/50)

The switch panel is not included in the remote control kit. It is available as an optional part.

Purchase this genuine Honda part as needed.

Follow the installation instructions on page 9. (The switch panel is standard on the BF75/90).

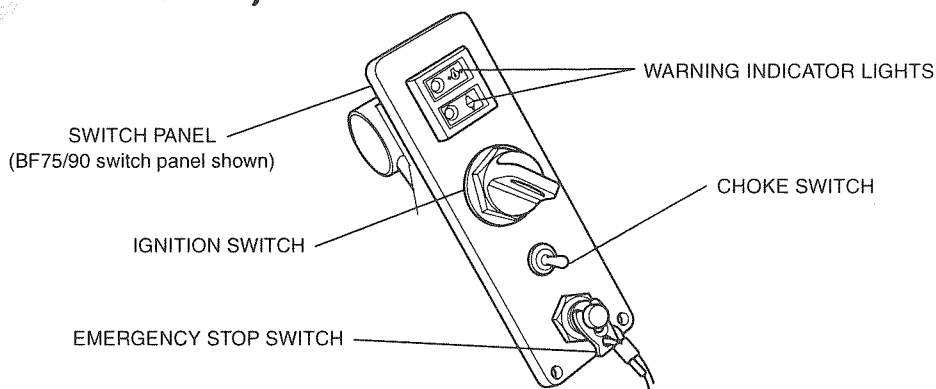

Choke Switch When the switch is the raised position (ON), the choke solenoid operates the choke. (not applicable to BF115 /130)

Warning Indicator Light The warning indicator lights show the condition on the outboard motor. (Engine oil pressure indicator light, overheat warning indicator light.)

Ignition Switch Operate the ignition switch to start and stop the outboard motor.

Emergency Stop Switch Operate the emergency stop switch to stop the engine in an emergency.

SPACER (Optional)

- The spacer is not included in the remote control kit. It is available as an optional part. Purchase a genuine Honda spacer for the outboard motor remote control kit as needed.
- Note that the installation height of the remote control increases 25 mm (0.98 in) by mounting the spacer.
- Check the spacer installation position and the surrounding area for freedom from interference and restriction.

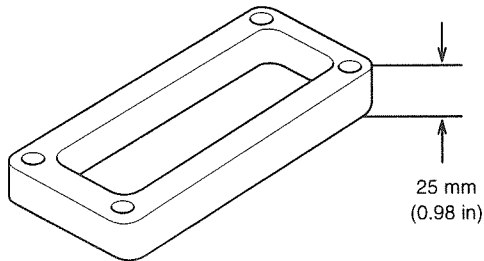

For single lever type
(P / N 06241-ZW5-U00)

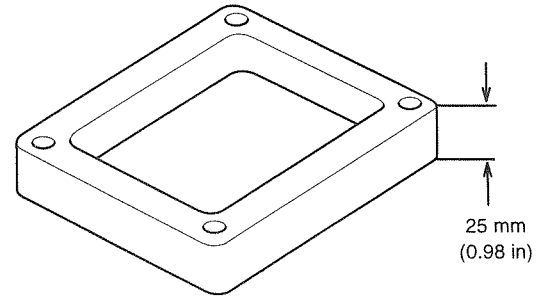

For dual lever type
(P / N 06241-ZW5-U10)

SHIFTING OPERATION PROCEDURE

Move the remote control lever to the neutral position. Push the fast idle button, and move the remote control lever a little forward to start the engine. The fast idle button can only be pushed when the remote control lever is in the neutral position. After starting the engine, warm up the engine. After warming up the engine, return the remote control lever to the neutral position, and shift into gear by moving the remote control lever to the forward or reverse range.

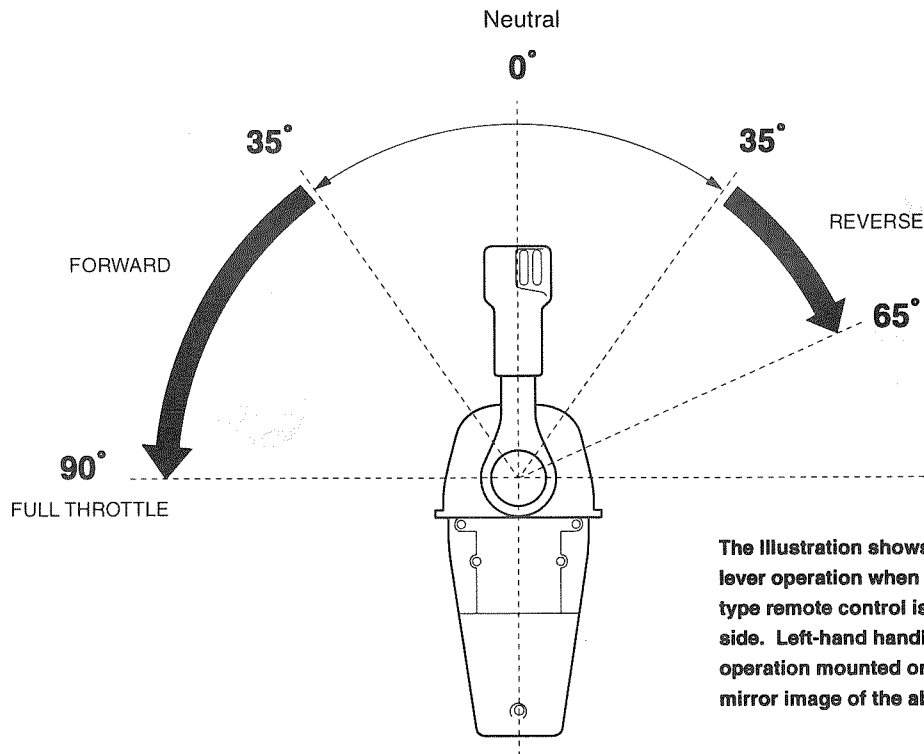

Move the remote control lever approximately 35° forward to engage forward gear or approximately 35° rearward to engage reverse gear. The throttle does not open unless the lever is turned 35° or more.

The fast idle button can only be pushed when the remote control lever is in the neutral position. The fast idle button automatically returns when the remote control lever is returned to the neutral position, and you can select the forward or reverse gear.